

WitaTrap® Complete Walnut Husk Fly Trap Set

Assembly of the WitaTrap® Balloon Trap:

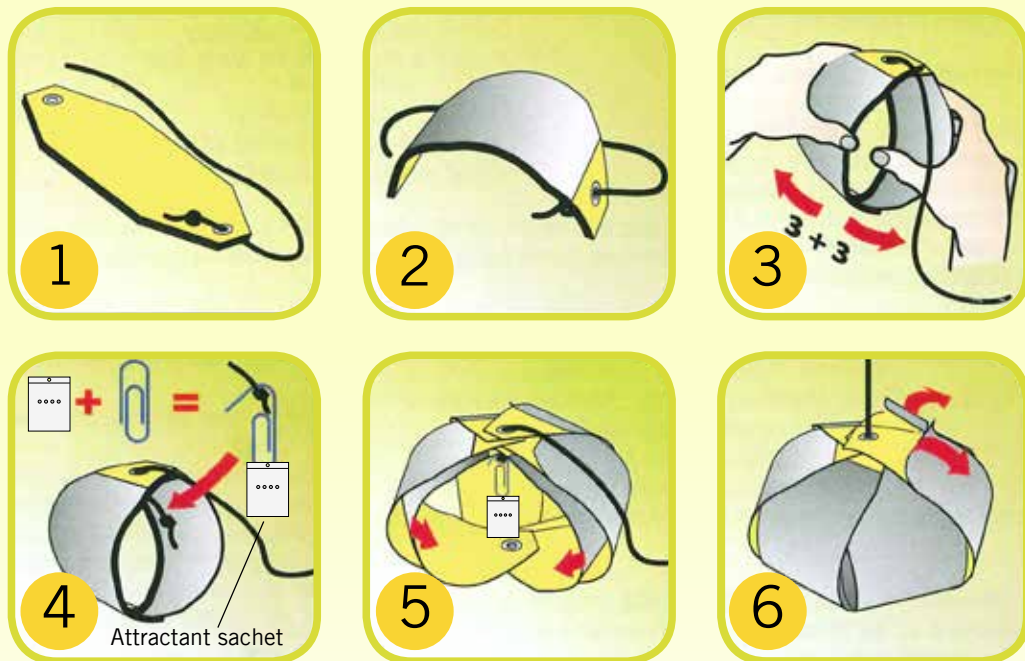

Assembly:

- 1 Lay the balloon trap out flat. Then bend the trap with the still covered adhesive surfaces upwards to give it a semicircular form.
- 2 Pull the adhesive surfaces apart. The suspension cord should be at the top and there should be at least three adhesive surfaces per side.
- 3 Remove the pheromone (attractant) from the aluminium sachet and attach it with the help of a paperclip to the centre of the balloon trap. **Important: The film over the visible holes of the attractant sachet must be removed in order to activate the pheromone. Take care not to damage the rest of the pheromone sachet surface.**
- 4 Once the pheromone is in place, fan out the adhesive surfaces left and right to form a balloon shape.
- 5 Now remove the protective films from the adhesive surfaces.
- 6 Suspend the assembled balloon trap in accordance with instructions. (See inside page)

Contents: **One trap set**

consisting of: 2 trap bodies (WitaTrap® Balloon Trap), 2 pheromone sachets (attractant) (separately packaged!), suspension cord for mounting and detailed instructions for use.

Art. No.: 343441



witasek® Witasek-Allee 2 • 9560 Feldkirchen/Austria • Tel.: +43 (0) 4276 / 3230
Fax: +43 (0) 4276 / 2088-399 • office@witasek.com • www.witasek.com

LEGAL NOTICE: Publisher responsible for contents: witasek PflanzenSchutz GmbH. Great care has been exercised in providing information. We can accept no liability for misprints and other errors. Contents may be subject to change without notice. Our general terms of supply and payment apply. To view our GTCs, go to www.witasek.com

witasek®



WitaTrap® Complete Walnut Husk Fly Trap Set



Walnut husk fly (*Rhagoletis completa*)

Biological
attractant trap
(pheromone trap)
for the management of
pest infestation
of your cultivars.



► See inside for more information

Walnut husk fly (*Rhagoletis completa*)

Pest: walnut husk fly
 Scientific name: *Rhagoletis completa*
 Infests: walnuts (*Juglans* spp.),
 black walnuts (*Juglans nigra*)



The walnut husk fly (*Rhagoletis completa*) is an introduced species and, as a beneficiary of climate change, is increasingly becoming a serious pest that damages mainly cultivated walnuts but also the wild-growing black walnut.

Main symptoms of infestation:

As a result of the feeding behaviour of the larvae, not only nutshells can become blackened and unattractive, but nuts can also be damaged. There is no damage to trees or leaves. There can be differences in the susceptibility of varieties to infestation by the pest. Early ripening varieties are more attractive to the pest than late ripening varieties.

Biology:

Similar to the European cherry fruit fly, the walnut husk fly only produces one generation per year, whereby insects overwinter (diapause phase) in pupa form in the soil.

Egg deposition: in late July, 12 - 15 eggs are laid under the skin of the fruit husks

Development phase: 5 days

Main flight phase: early July to late September

Optimal conditions: long, warm summers

The use of pheromone traps is an excellent way of controlling levels of pest insects.

Purpose of pheromone traps:

- They are used to monitor levels of infestation and to determine when adults are taking flight. Further suitable targeted measures (biological or standard plant protection methods) can then be initiated as necessary.
- Reduction of numbers of pest insects.

Use:

Assemble the trap and hang it from a branch or post.
 (See other side for assembly instructions)

In order to avoid attracting the pest insects directly to the nut tree to be protected, hang the trap from another tree (that is not a nut tree) in the vicinity. If this is not possible, the trap can also be hung from a suitably high post driven into the ground.

Hang the trap at eye level between the main wind direction and the tree. Make sure the trap entrances are not blocked by twigs and leaves.

Each trap should be checked at regular intervals of 2 - 3 days. Each time a trap is checked, the insects sticking to the adhesive surfaces should be removed using a suitable tool (e.g. twig or wooden scraper) to ensure that the full glue surface is revealed. If surfaces become very soiled, replace the trap or spray with a liquid glue, such as Soveurode special glue.

Replace the attractant and the trap if necessary roughly every 4 - 8 weeks.

*Traps should be put in place before the flight phase of the adults.

Storage:

Store the pheromones prior to use in the original packaging in a cold place (e.g. refrigerator or freezer compartment) at a maximum temperature of +4°C (no risk to foodstuffs).

Disposal:

Used traps can be disposed of with domestic waste.

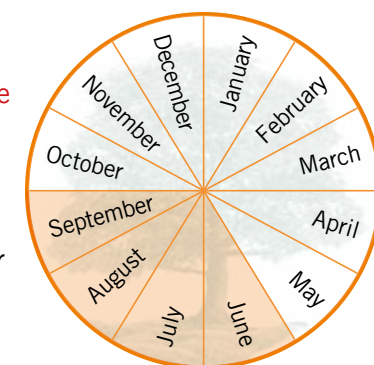

Period of use*

Trap set

Art. No.	Product
343441	WitaTrap® Complete Walnut Husk Fly Trap Set (<i>Rhagoletis completa</i>)

Reconditioning

If adhesive surfaces collect too many insects and traps become badly soiled, these should be replaced or resprayed with a liquid glue, such as Soveurode special glue.

Art. No.	Product
381211	Soveurode special glue (sprayable glue)

Orders can be placed by phone, fax or email.

Tel.: +43 (0)4276/ 3230 | Fax: +43 (0) 4276/ 2088-399 | Email: office@witasek.com